

PB600

Universal Effects Pedal Board

Ultra-compact and lightweight pedal board for transporting up to 6 effects pedals, including patch cables

Generous 1.7 A power adapter included for powering more than 12 devices*—includes 1 x 6 daisy-chain cabling

Ultra-rigid plastic design withstands even heavy impact

High-quality components and exceptionally rugged construction ensure long life

Conceived and designed by BEHRINGER Germany

* Depends on the power consumption of the effects pedals, etc.

behringer.com

Footswitches and Controllers

Pedal Board with 9 V DC Power Supply and Patch Cables



When effects are an integral part of your rig, their power adapters and patch cables can often be the most vulnerable part, and the most likely to sabotage your set if they're not pampered. Rather than tossing your pedals, power adapters and all other cabling into a duffel bag after a gig, keep them safe—and ready to rock at a moment's notice—with the PB600.

It's all about connections

This awesome pedal board makes hooking up six 2.5" x 4.5" pedals as easy as hooking up just one (of course, if you're using pedals that aren't 2.5" x 4.5", the snug foam padding can be cut to accommodate pedals of varying shapes). The PB600 includes ¼" patch cables, so you can leave your pedals connected to one another, ready to pass signal even when you're transporting them. It also comes with 1 x 6 daisy chain cabling so that when you plug in the 1.7 A power adapter, all your pedals receive power. Meanwhile, all cabling remains safe and free of strain. Failure is almost guaranteed when you're dealing with a rat's nest of loose cabling, but with the PB600, your effects chain is always safe and organized.

Continued on next page

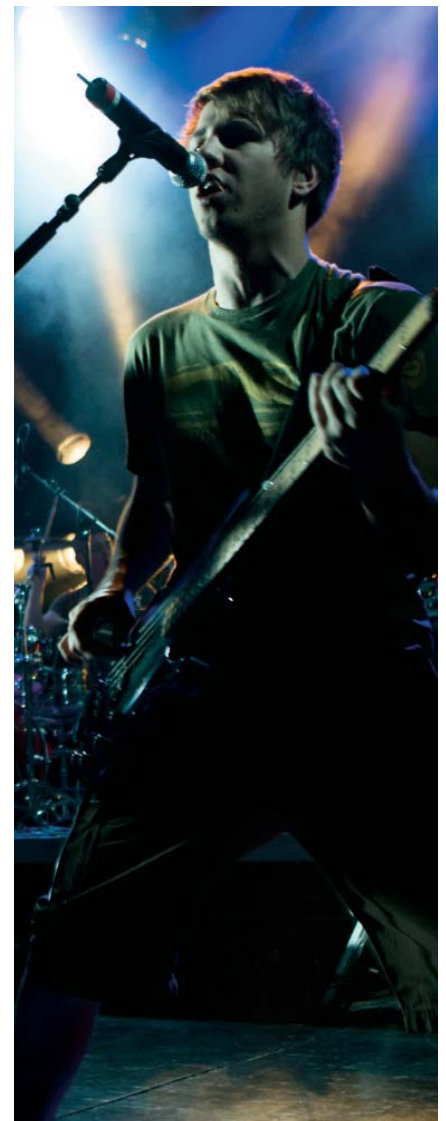

PB600

Universal Effects Pedal Board

Connect your guitar, bass or keyboard to the single 1/4" input in the upper right corner of the board. A pair of 1/4" FROM EFFECTS jacks in the upper left corner allow you to connect stereo effects, and two 1/4" OUTPUT TO AMP jacks send a left and right stereo signal up to two amps.

When it's time to load out, just unplug the power supply, disconnect your guitar and amp, put the lid back on the PB600 and slide the locking latches back into place. The heavy-impact plastic casing will protect your pedals from the very worst dings, scrapes and scratches the road throws your way.

Hookup Diagram

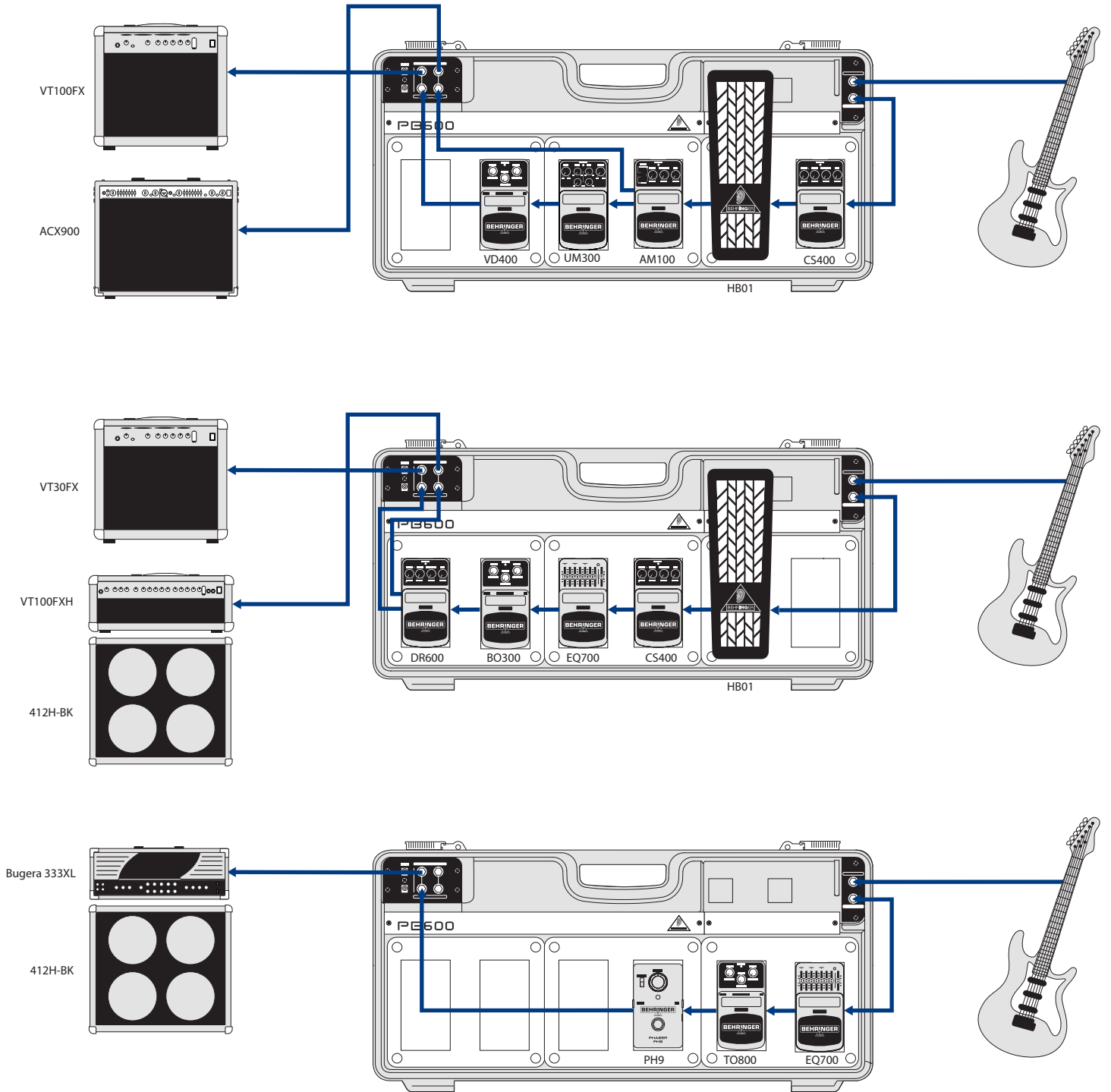

PB600

Universal Effects Pedal Board

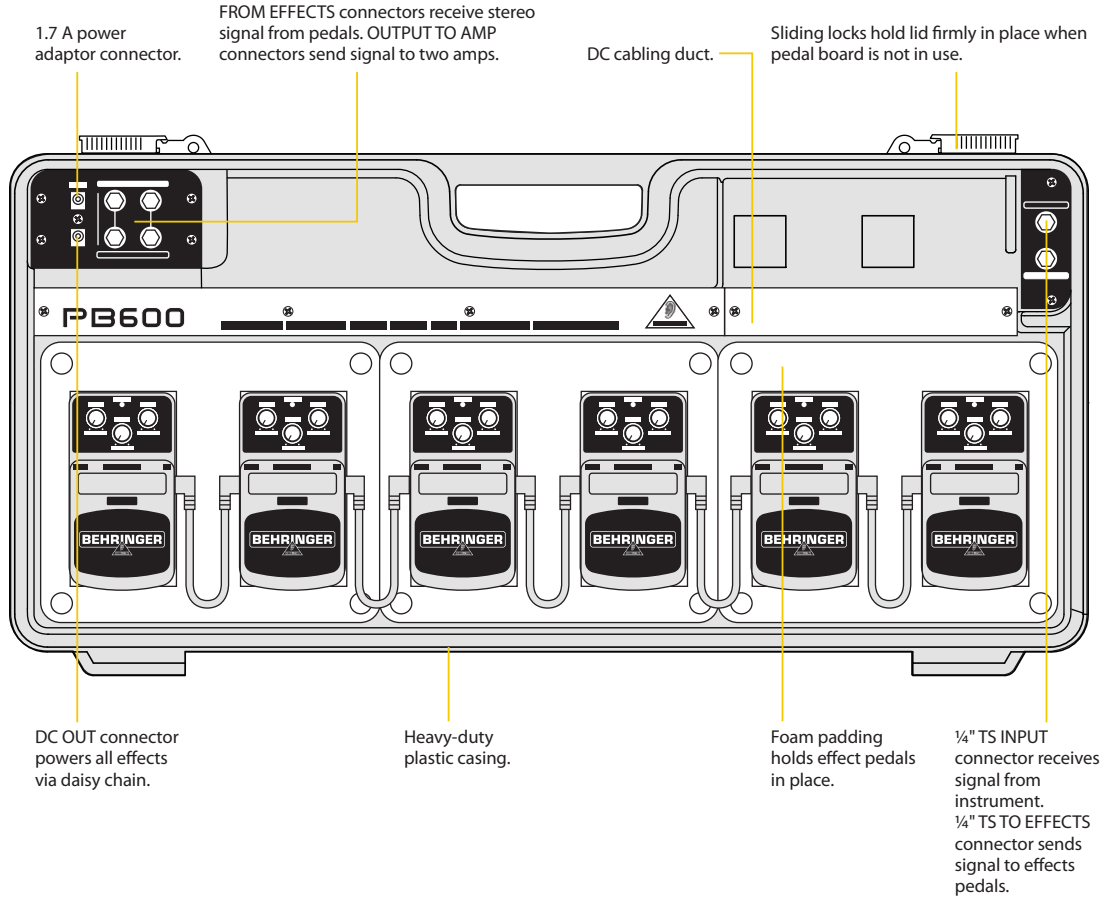

SPECIFICATIONS

Connectors	1/4" TS, unbalanced
Power supply	9 V, 1.7 A switching adaptor(included)
USA/Canada 120 V~, 60 Hz	GPE182-090170-1 (HSB-UL)
Europe/Australia 230 V~, 50 Hz	GPE182-090170-2 (HSB-EU)
U.K.	GPE182-090170-3 (HSB-UK)
Korea 220 V~, 60 Hz	GPE182-090170-4 (HSB-SAA)
China 220 V~, 50 Hz	GPE182-090170-5 (HSB-CCC)
Japan 100 V~, 50/60 Hz	GPE182-090170-6 (HSB-JP)
Power connector	2 mm DC jack, center negative (with daisy-chain cable included)
Power consumption	2 mA

Dimensions (H x W x D)

PB1000	504.3 mm (19 7/8") x 663.6 mm (26 1/8") x 115 mm (4 1/2")
PB600	329 mm (13") x 663.6 mm (26 1/8") x 115 mm (4 1/2")

Weight

PB1000	approx. 5.33 kg (11.8 lbs) including PSU & daisy chain
PB600	approx. 3.8 kg (8.4 lbs.) including PSU & daisy chain

BEHRINGER is constantly striving to maintain the highest professional standards. As a result of these efforts, modifications may be made from time to time to existing products without prior notice. Specifications and appearance may differ from those listed or illustrated.

Order via the BEHRINGER 24/7 Dealer Portal or contact the BEHRINGER location nearest you:

BEHRINGER Australia tel.: +61 3 9877 7170, fax: +61 3 9877 7870 **BEHRINGER Germany** tel.: +49 2154 9206 4149, fax: +49 2154 9206 4199 **BEHRINGER Japan** tel.: +81 3 5281 1180, fax: +81 3 5281 1181 **BEHRINGER Singapore** tel: +65 5845 1800, fax: +65 6214 0275 **BEHRINGER USA / CANADA** tel: +1 425 672 0816, fax: +1 425 673 7647

behringer.com

